



Installation manual and safety information

Number plate holder for changeable number plates





Caution



Important safety advice:

- Working on motorcycles poses a safety risk. Some work may only be carried out by appropriately qualified personnel. Faulty work can have serious consequences and may pose a threat to life and health. Only undertake installation works if you are sufficiently qualified and have an official workshop manual as well as all relevant service notifications available. Otherwise, we strongly recommend that the installation is carried out or at least checked in a specialist workshop.
- Any work in relation to the installation, removal and tightening torque of original parts should always be carried out in compliance with the workshop manual.
- All screws must be attached with thread-locking fluid. However, this should only be done after the installation is complete.
- It is your responsibility to check the product regularly and to determine if a service or replacement is required.
- Please bear in mind that some products are safety-relevant parts of your vehicle. After a fall or collision, check the product and if there is the slightest indication of damage, you must completely replace it.
- Some products require registration.
- These products have been designed for a standard vehicle. ABM® Fahrzeugtechnik GmbH makes no warranty or guarantee of any kind for any damages whatsoever arising out of the combination with other component parts not tested by ABM, as a consequence of improper installation or inadequate maintenance.
- Please read the entire safety information and installation manual carefully.
- A motorcycle not securely positioned can fall over during the following work. Therefore, make sure that the motorbike is positioned on solid, flat ground and is secured against falling over and rolling away.
- Keep children and pets away from the work area.
- Protect removed parts from damage.
- When disassembling individual parts, please note which screws are used to fasten them. Keep these parts and screws and unless specified otherwise, reuse when assembling.
- After completing the work, check the firm fit, function and tightness of all components and screws.
- Afterwards, a test drive must be carried out! After completion of the test drive, all screw connections must be re-checked for firm fit, tightness and all movable parts for adequate free travel. Re-test the front wheel's freewheel and check the brake system for overheating. Check the brake fluid level in the reservoir for significant changes.

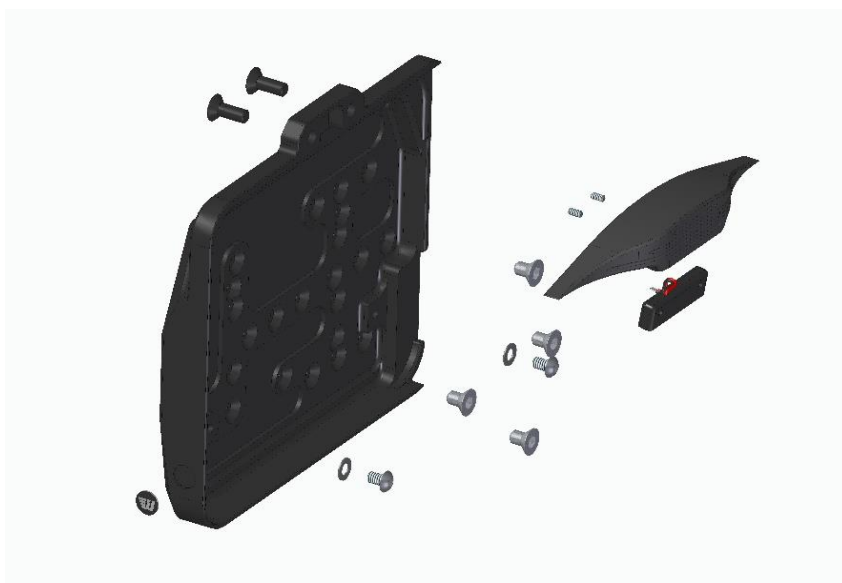

CAUTION:

To attach the number plate, the number frame set (D9930-ALU-82) is required.
This is not included in the delivery.



Attach the baseplate and number plate lighting according to the model-specific installation manual.



Align the springplate from the number frame set and attach to the baseplate using the two screws and safety washers provided.

Use thread-locking fluid (medium strength)

Tightening torque 5 Nm



Attach the number plate to the number frame.

Next, slide the number frame over the spring mechanism into the springplate and click into place.