

WUNDERKIND

CUSTOM

LED indicator



Installation and safety information

for

Husqvarna Vitpilen 401/701

from model year 2018



Caution



Important safety advice:

- Work undertaken on wheels and wheel axles poses a safety risk. This work may only be carried out by appropriately qualified personnel. Faulty work can have serious consequences and may pose a threat to life and health. Only undertake this installation if you are sufficiently qualified and have an official workshop manual as well as all relevant service notifications available. Otherwise, we strongly recommend that the installation is carried out or at least checked in a specialist workshop.
- Any work in relation to the installation, removal and tightening torque of original parts should always be carried out in compliance with the workshop manual.
- All screws must be attached with thread-locking fluid. However, this should only be done after the installation is complete.
- It is your responsibility to check the product regularly and to determine if a service or replacement is required.
- Please bear in mind that this product is a safety-relevant part of your vehicle. After a fall or collision, check the product and if there is the slightest indication of damage, you must replace it.
- This product requires registration.
- This product has been designed for a standard vehicle. ABM® Fahrzeugtechnik GmbH makes no warranty or guarantee of any kind for any damages whatsoever arising out of the combination with other component parts not tested by ABM, as a consequence of improper installation or inadequate maintenance.

1 Preparation

- Please read the entire safety information and installation manual carefully.
- A motorcycle not securely positioned can fall over during the following work. Therefore, make sure that the motorbike is positioned on solid, flat ground and is secured against falling over and rolling away.
- Keep children and pets away from the work area.
- Protect removed parts from damage.
- When disassembling individual parts, please note which screws are used to fasten them. Keep these parts and screws and unless specified otherwise, reuse when assembling.

2 Content

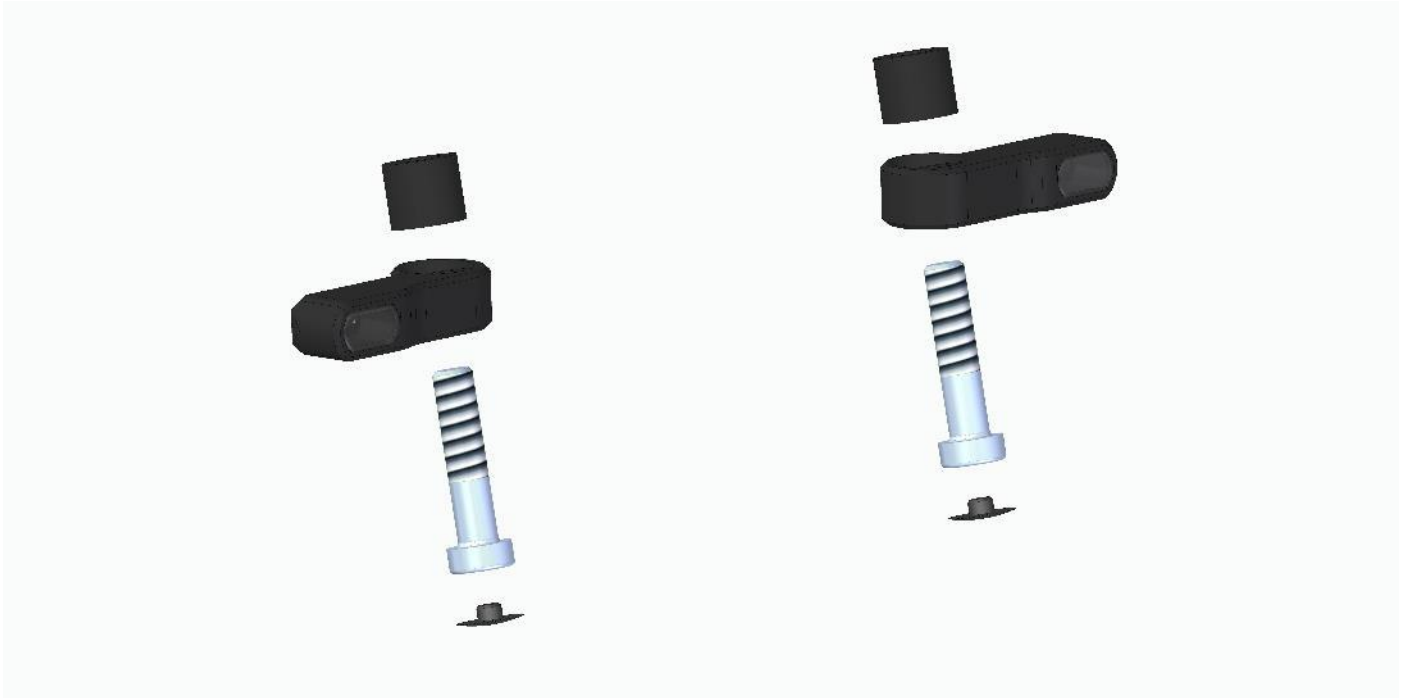

Remove the two front plastic clips on the rear underside.



Attach both indicators to the rear underside using the screws and spacer bushings provided.

Push the enclosed caps into the screws.



Drill into the covering next to the indicators (\varnothing 3 mm) to guide through the cables.



Connect the indicator with the cable harness. Use the solder connectors provided to do this and observe the polarity.

Tip: Lay the entire cable harness under the pillion seat.



Check the proper function of the two indicators and the complete electrical system. The indicator frequency must correspond to the original.

Tip: In case of deviations, a load-independent indicator relay (not included in the delivery) can be used instead of the original. The original indicator relay is mounted in the frame triangle, on the left-hand side.

4 Final check

- All electric wires must be laid in a manner which prevents them from bending or getting pulled during spring deflection movements and which adequately protects them against rubbing.
- After completing the work, check that all components and screws are tight and functioning correctly.
- Afterwards, a test drive must be carried out! After completing the test drive, the tightness of all screw connections must be checked, as well as the adequate free travel of all moving parts