



Installation manual and safety information



LED front indicator

for

Indian Springfield from model 2021



Caution



Important safety advice:

- Working on motorcycles poses a safety risk. Some work may only be carried out by appropriately qualified personnel. Faulty work can have serious consequences and may pose a threat to life and health. Only undertake installation works if you are sufficiently qualified and have an official workshop manual as well as all relevant service notifications available. Otherwise, we strongly recommend that the installation is carried out or at least checked in a specialist workshop.
- Any work in relation to the installation, removal and tightening torque of original parts should always be carried out in compliance with the workshop manual.
- All screws must be attached with thread-locking fluid. However, this should only be done after the installation is complete.
- It is your responsibility to check the product regularly and to determine if a service or replacement is required.
- Please bear in mind that some products are safety-relevant parts of your vehicle. After a fall or collision, check the product and if there is the slightest indication of damage, you must completely replace it.
- Some products require registration.
- These products have been designed for a standard vehicle. ABM® Fahrzeugtechnik GmbH makes no warranty or guarantee of any kind for any damages whatsoever arising out of the combination with other component parts not tested by ABM, as a consequence of improper installation or inadequate maintenance.

1 Preparation

- Please read the entire safety information and installation manual carefully.
- A motorcycle not securely positioned can fall over during the following work. Therefore, make sure that the motorbike is positioned on solid, flat ground and is secured against falling over and rolling away.
- Keep children and pets away from the work area.
- Protect removed parts from damage.
- When disassembling individual parts, please note which screws are used to fasten them. Keep these parts and screws and unless specified otherwise, reuse when assembling.

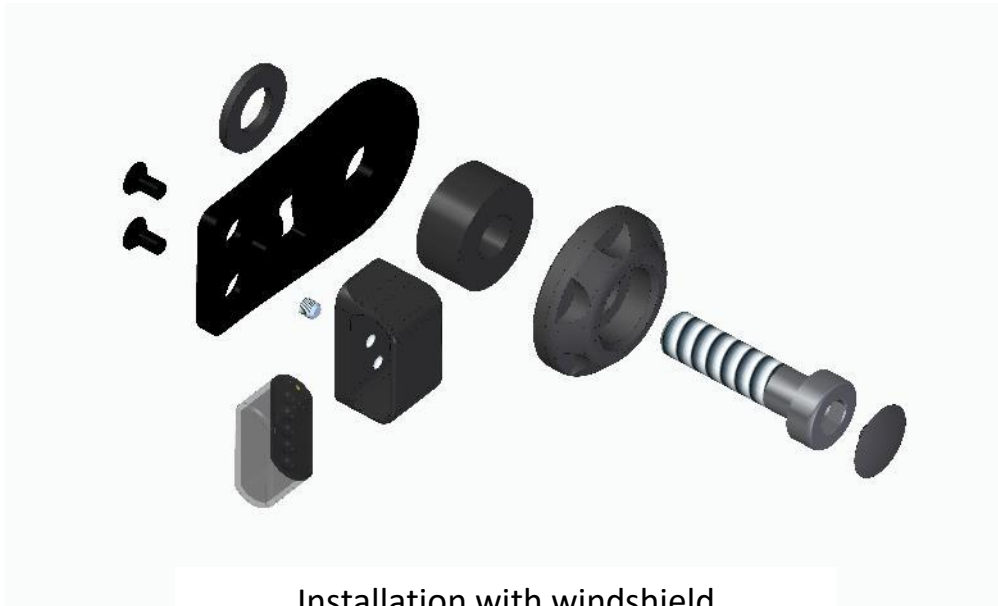



Make sure that the motorbike is securely positioned.



Loosen the six screws of the headlight covering.



Carefully remove the rear covering.



Disconnect the left and right indicators behind the headlight and remove completely including bracket.



Cut the cables of the original indicators approx. 5 cm after the plug.

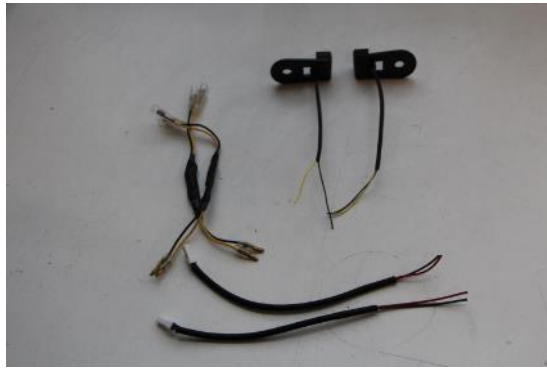

Solder all cable ends together.
Use the resistors and solder connectors provided to do this.

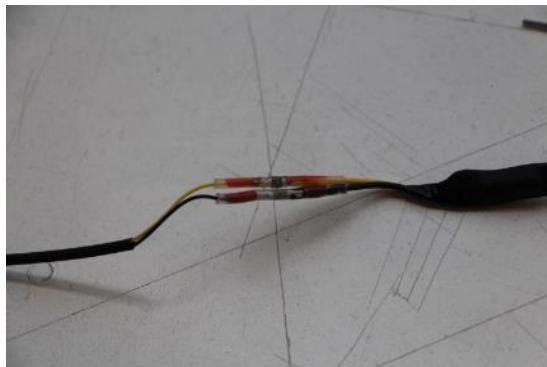

Cable colour black is ground.



Lightly attach the top of the headlight covering.



Lay the indicator cable through the rubber nozzle and behind the covering to the plug.



Connect the plug and attach the cables to the fork using cable ties.



Check that both indicators are functioning.



Carefully reattach the headlight covering. Use the black screws provided at the top yoke.



Mount the indicators with the brackets provided, align and attach all six screws of the headlight covering.



Push the plastic covering into the screw at the indicator.

After installation, the functioning of the vehicle must be fully checked.

4 Final check

- All electric wires must be laid in a manner which prevents them from bending or getting pulled during spring deflection movements and which adequately protects them against rubbing.
- After completing the work, check that all components and screws are tight and functioning correctly. Also check the rear wheel's freewheel and the functionality of the brake system.
- Afterwards, a test drive must be carried out! After completing the test drive, the tightness of all screw connections must be checked, as well as the adequate free travel of all moving parts. Re-test the rear wheel's freewheel and check the brake system for overheating.