

WUNDERKIND CUSTOM

Installation manual and safety information

Risers



Indian Chief

From model year 2021



Caution



Important safety advice:

- Working on motorcycles poses a safety risk. Some work may only be carried out by appropriately qualified personnel. Faulty work can have serious consequences and may pose a threat to life and health. Only undertake installation works if you are sufficiently qualified and have an official workshop manual as well as all relevant service notifications available. Otherwise, we strongly recommend that the installation is carried out or at least checked in a specialist workshop.
- Any work in relation to the installation, removal and tightening torque of original parts should always be carried out in compliance with the workshop manual.
- All screws must be attached with thread-locking fluid. However, this should only be done after the installation is complete.
- It is your responsibility to check the product regularly and to determine if a service or replacement is required.
- Please bear in mind that some products are safety-relevant parts of your vehicle. After a fall or collision, check the product and if there is the slightest indication of damage, you must completely replace it.
- Some products require registration.
- These products have been designed for a standard vehicle. ABM® Fahrzeugtechnik GmbH makes no warranty or guarantee of any kind for any damages whatsoever arising out of the combination with other component parts not tested by ABM, as a consequence of improper installation or inadequate maintenance.
- Brake fluid may damage painted surfaces and fairings. Use suitable means to protect all of the surfaces against damage.

1 Preparation

- Please read the entire safety information and installation manual carefully.
- A motorcycle not securely positioned can fall over during the following work. Therefore, make sure that the motorbike is positioned on solid, flat ground and is secured against falling over and rolling away.
- Keep children and pets away from the work area.
- Protect removed parts from damage.
- When disassembling individual parts, please note which screws are used to fasten them. Keep these parts and screws and unless specified otherwise, reuse when assembling.

2 Content



3 Installation



Make sure that the motorbike is securely positioned.

Cover all parts in the handlebar area (tank, speedometer, fender) for protection.



Loosen the two upper screws of the original risers by half a turn.



Attach the cover to the risers using the button head screws provided.

Tightening torque 3 Nm

Use thread-locking fluid (medium strength)

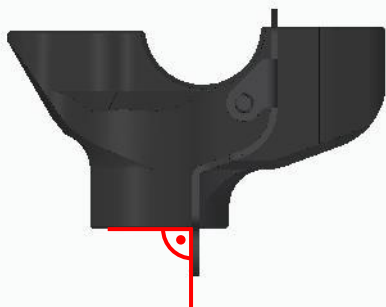

To do this, align the cover at a right angle to the mounting surface of the risers.



Loosen the two screws of the original risers on the underside of the top yoke and place the handlebar onto a pad on the tank.



Loosen the original risers with speedometer and completely remove with the handlebar.
Be careful not to twist the position of the handlebar.

Tip: The assistance of a second person simplifies the disassembly.



Use the original screws to screw the new risers onto the handlebar and speedometer from above.

Caution:

During assembly, make sure that there is no gap on the front between the upper and lower parts.



Tighten the risers from below using the cylinder head screws provided.

Use thread-locking fluid (medium strength).

Tightening torque 20 Nm



Finally, fasten the risers to the top yoke using the two original screws.

Use thread-locking fluid (medium strength).

Tightening torque according to manufacturer's specifications.

Caution: During assembly, make sure that there is enough space between speedometer and the tank.



After the final assembly, check the freedom of movement of all lines and cables and fasten them only to such an extent that they are not bent, do not chafe and are tension-free in maximum steering angle and over the entire spring travel.

4 Final check

- Make sure that all operating elements present on the handlebar are adequately positioned, even in maximum steering angle. The brake and clutch cylinders must be in an adequate operating position.
- Pay attention to the freedom of movement of the handlebar, its mounted parts and adequate steering angle to each side. The handlebar must be able to be moved easily from steering angle to steering angle. Check the free play of the accelerator cables: In maximum steering angle to both sides and with the engine running, the motor speed must not change.
- After completing the work, check the firm fit, function and tightness of all components and screws. Make sure that there is sufficient brake fluid in the reservoir. Also check the front wheel's freewheel and the functionality of the brake system. Further, the function of the clutch, the throttle grip, the electric system and the anti-theft devices must be checked.
- Afterwards, a test drive must be carried out! After completion of the test drive, all screw connections must be re-checked for firm fit, tightness and all movable parts for adequate free travel. Re-test the front wheel's freewheel and check the brake system for overheating. Check the brake fluid level in the reservoir for significant changes.