

## *Rear lighting*



**Installation and safety information  
for  
Harley-Davidson Nightster from model year 2022**



## Caution



### Important safety advice:

- Work undertaken on wheels and wheel axles poses a safety risk. This work may only be carried out by appropriately qualified personnel. Faulty work can have serious consequences and may pose a threat to life and health. Only undertake this installation if you are sufficiently qualified and have an official workshop manual as well as all relevant service notifications available. Otherwise, we strongly recommend that the installation is carried out or at least checked in a specialist workshop.
- Any work in relation to the installation, removal and tightening torque of original parts should always be carried out in compliance with the workshop manual.
- All screws must be attached with thread-locking fluid. However, this should only be done after the installation is complete.
- It is your responsibility to check the product regularly and to determine if a service or replacement is required.
- Please bear in mind that this product is a safety-relevant part of your vehicle. After a fall or collision, check the product and if there is the slightest indication of damage, you must replace it.
- This product requires no registration.
- This product has been designed for a standard vehicle. ABM® Fahrzeugtechnik GmbH makes no warranty or guarantee of any kind for any damages whatsoever arising out of the combination with other component parts not tested by ABM, as a consequence of improper installation or inadequate maintenance.

## 1 Preparation

- Please read the entire safety information and installation manual carefully.
- A motorcycle not securely positioned can fall over during the following work. Therefore, make sure that the motorbike is positioned on solid, flat ground and is secured against falling over and rolling away.
- Keep children and pets away from the work area.
- Protect removed parts from damage.
- When disassembling individual parts, please note which screws are used to fasten them. Keep these parts and screws and unless specified otherwise, reuse when assembling.

2 Content

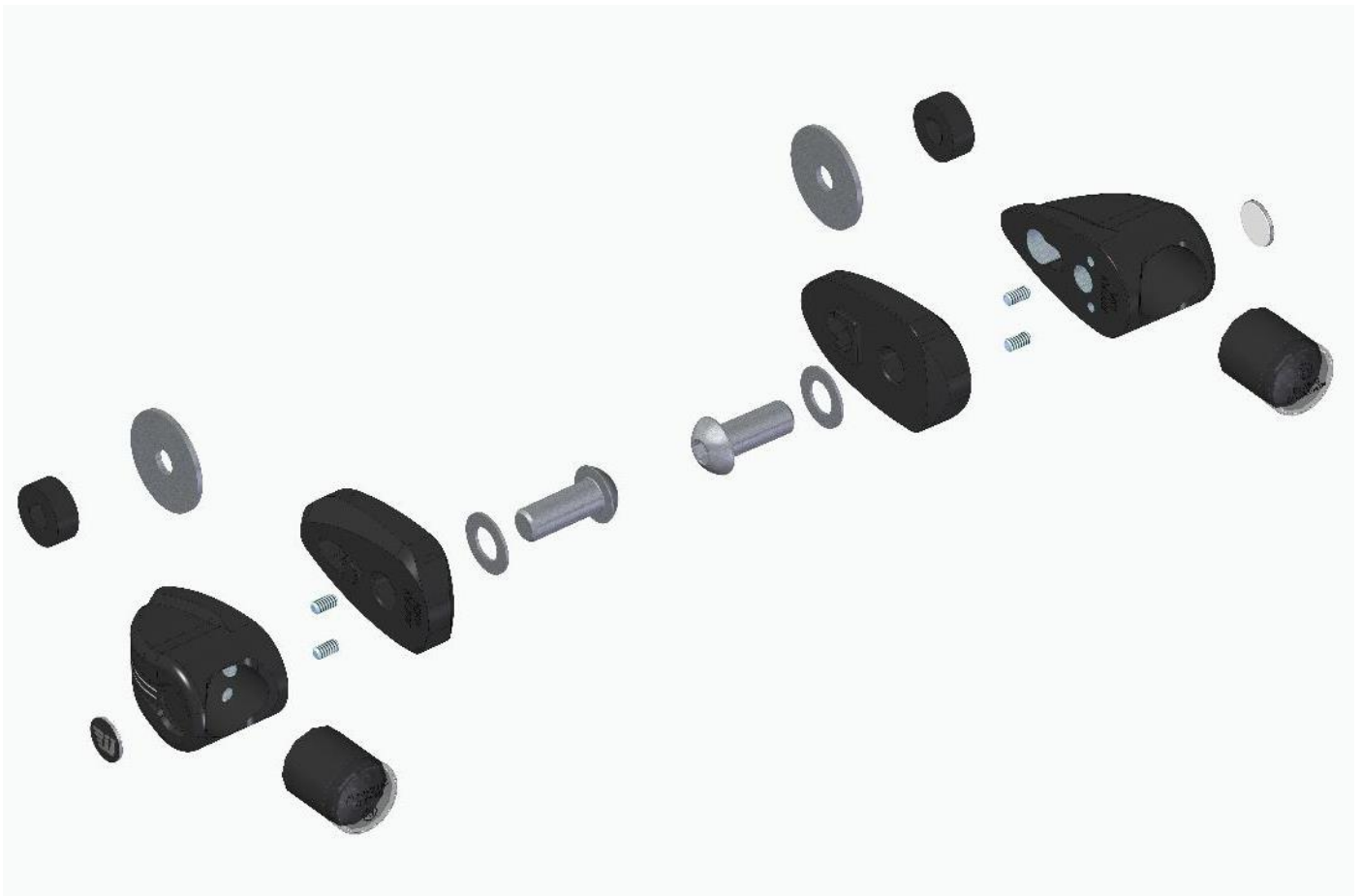

# Installation Manual



## Installation:

Park the vehicle safely.



Remove the seat and both side covers.



Unplug the plug connectors of the indicators and the tail light.



Completely remove the left rear bracket.



Remove the cable harness for the tail light from the holders.

## Installation Manual



Remove the number plate holder.



Unscrew the indicator from the rear support and detach the cable from the adhesive holders.



Drill out the fixing hole to 8 mm.



Attach the enclosed tail light/indicator combinations to the bracket with an adapter, safety washer and screw.



Attach the cable to the bracket with the holders.

## Installation Manual



Mount the rear bracket to the vehicle.  
Fix all removed parts on the left side.

Torque according to manufacturer's specifications.

Lay the lighting cable under the seat.



Repeat the procedure on the right side.

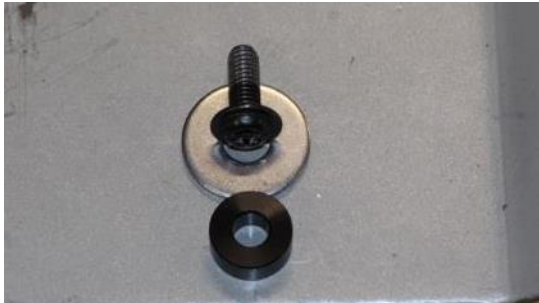

Tighten the fender with the supplied spacer, washer and original screw.



*Note: Tightening the screw only serves to ensure that the distance from the fender to the bracket is the same.*



Cut the connectors of the original lighting and solder them to the cable ends according to the plan using the supplied solder connectors. Observe the polarity.



Reattach all unscrewed parts.

*Note: After installation, the proper functioning of the vehicle electrics must be checked!*



## Wiring diagram for Harley-Davidson Nightster from 2022 LED tail light/indicator combination

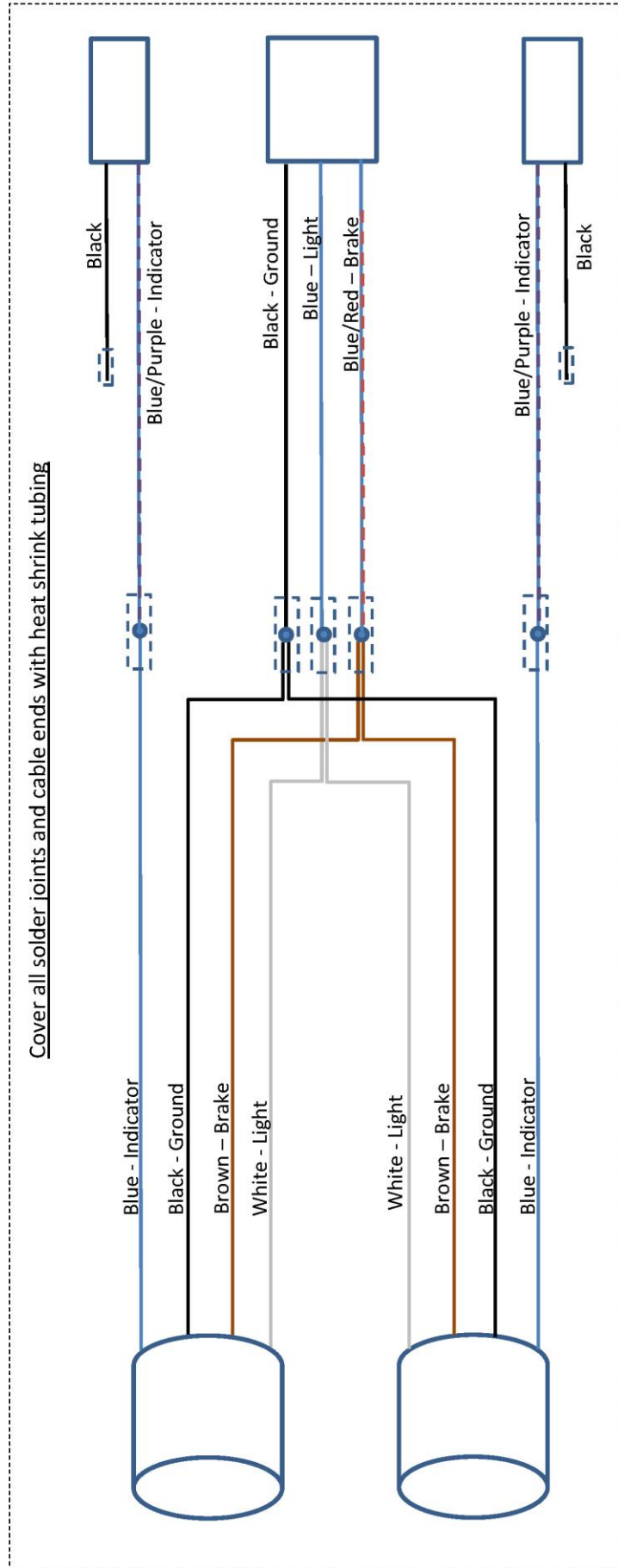

## 3 Final check

- All electric wires must be laid in a manner which prevents them from bending or getting pulled during all spring deflection movements and which adequately protects them against rubbing.
- After completing the work, check that all components and screws are tight and functioning correctly. Also check the rear wheel's freewheel and the functionality of the brake system.
- Afterwards, a test drive must be carried out! After completing the test drive, the tightness of all screw connections must be checked, as well as the adequate free travel of all moving parts. Re-test the rear wheel's freewheel and check the brake system for overheating.

